

Moving You



Coombes Way, North Common, BS30 8YP Asking Price £250,000
03334041188 option 3 guy.rolfe@moving-you.co.uk

Freehold
www.moving-you.co.uk









Coombes Way, North Common, Bristol, BS30 8YP

This immaculate end of terrace house, located in a sought-after area, is perfect for discerning buyers, featuring an open-plan reception room with garden access, a versatile upstairs space, a master bedroom, a delightful kitchen, and a garden with a single garage.

Welcome to this immaculate end of terrace house, a gem tucked away in a sought-after location. This property is a perfect haven for buyers who appreciate the finer things in life. The house, brimming with warmth and charm, is presented in a pristine condition, ready for you to create your own home sweet home.

As you step into the house, you're greeted by an open-plan reception room that overlooks the garden. The room is bathed in natural light, creating a bright and welcoming space where you can unwind or entertain guests. The room features direct access to the garden, inviting you to step outside and enjoy the fresh air whenever you please.

Upstairs, you'll find the living room. This is a versatile space that you can adapt to suit your needs. Whether you want a cosy evening lounge or a home office, this space gives you the freedom to create your dream room.

The property boasts a master bedroom that promises a restful night's sleep. The kitchen, with its open-plan design, is a delight for those who love cooking. The shower room adds a touch of luxury to your daily routine.

A single garage provides secure parking or extra storage which also has the benefit of internal access. The garden is a real highlight, offering a tranquil space where you can relax, entertain, or indulge your green thumb.

This property truly is a dream come true for buyers. Don't miss out on the opportunity to make it your own.

Council Tax Band B







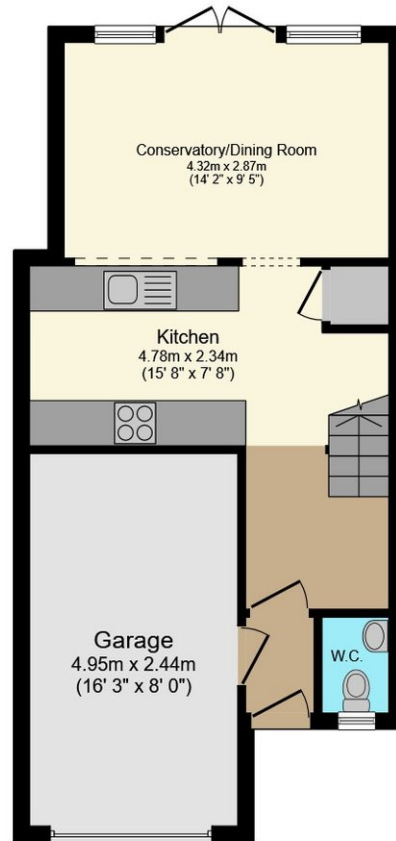

Ground Floor

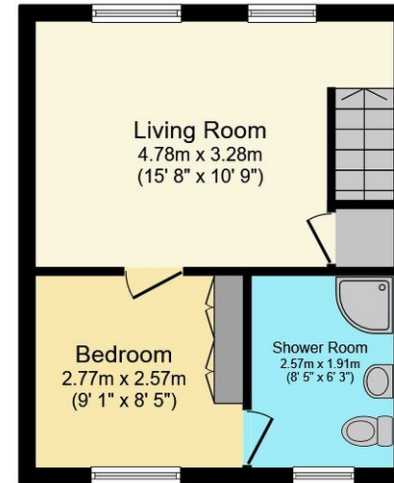

First Floor

This floor plan is for illustrative purposes only. It is not drawn to scale. Any measurements, floor areas (including any total floor area), openings and orientations are approximate. No details are guaranteed, they cannot be relied upon for any purpose and do not form any part of any agreement. No liability is taken for any error, omission or misstatement. A party must rely upon its own inspection(s). Powered by www.Propertybox.io

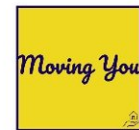

Guy Rolfe Moving You

03334041188 option 3

guy.rolfe@moving-you.co.uk

PROPERTY MISDESCRIPTIONS ACT 1991: The Agents has not tested any apparatus, equipment, fixtures and fittings, or services, so cannot verify that they are in working order or fit for the purpose. The buyer is advised to obtain verification from his or her Professional Buyer, References to the Tenure of the property are based on information supplied by the Vendor. The agents have not had sight of the title documents. The buyer is advised to obtain verification from their Solicitor. You are advised to check the availability of any property before travelling any distance to view.

www.moving-you.co.uk