

Moving You



Mill Lane, Warmley, BS30 8BN

03334041188 option 3

Asking Price £325,000

guy.rolfe@moving-you.co.uk

Freehold

www.moving-you.co.uk









Mill Lane, Warmley, Bristol, BS30 8BN

This charming end of terrace cottage in a friendly neighbourhood offers two reception rooms, a light and airy kitchen, two spacious bedrooms, a three-piece bathroom, downstairs W.C, and a beautiful garden, making it an ideal opportunity for first-time buyers or families seeking a welcoming home near schools and local amenities. Welcome to this charming end of terrace cottage, perfectly located in a friendly neighbourhood close to schools, local amenities and cycling routes via the Bristol & Bath cycle way. This home has been neutrally decorated throughout, providing a blank canvas for you to add your own personal touch.

Stepping through the front door, you'll find two delightful reception rooms. The first is a cosy haven complete with a lovely feature fireplace recess where you can curl up on the sofa with a good book. The dining room, great for family gatherings or entertaining guests is an open-plan space which seamlessly connects with the kitchen and enjoys natural light that floods through the twin skylight windows to the rear. The property also boasts two bedrooms; the master bedroom and a well-sized double room. Both rooms offer ample space for comfort and storage.

To top it off, there's a neat three-piece bathroom providing everything you need for a refreshing start to the day or a relaxing soak in the evening and a very handy downstairs W.C.

This home isn't just about the interior, it also offers a beautiful garden. Whether you're a keen gardener or simply love to sit out in the sunshine with a cup of tea, this outdoor space is sure to be a hit.

Ideal for first-time buyers or young families looking for their next step, this house offers a fantastic opportunity to create a lovely home. Don't miss out on this opportunity, get in touch to arrange a viewing today!

Council Tax Band B









Ground Floor

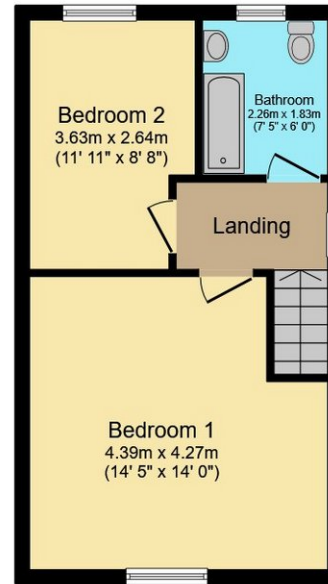

First Floor

This floor plan is for illustrative purposes only. It is not drawn to scale. Any measurements, floor areas (including any total floor area), openings and orientations are approximate. No details are guaranteed, they cannot be relied upon for any purpose and do not form any part of any agreement. No liability is taken for any error, omission or misstatement. A party must rely upon its own inspection(s). Powered by www.Propertybox.io



Guy Rolfe Moving You

03334041188 option 3

guy.rolfe@moving-you.co.uk

PROPERTY MISDESCRIPTIONS ACT 1991: The Agents has not tested any apparatus, equipment, fixtures and fittings, or services, so cannot verify that they are in working order or fit for the purpose. The buyer is advised to obtain verification from his or her Professional Buyer, References to the Tenure of the property are based on information supplied by the Vendor. The agents have not had sight of the title documents. The buyer is advised to obtain verification from their Solicitor. You are advised to check the availability of any property before travelling any distance to view.

www.moving-you.co.uk