

Moving You



Green Park, Southway Drive, BS30 5LF

03334041188 option 3

Asking Price £317,000

guy.rolfe@moving-you.co.uk

Freehold

www.moving-you.co.uk









Green Park, Bristol, BS30 5LF

This charming end-of-terrace house is perfect for first-time buyers, offering a bright open-plan reception room with garden views, a cosy kitchen, two lovely bedrooms including a master with a mezzanine balcony, and a bathroom with a skylight, all nestled in a location rich with green spaces and cycling routes.

Welcome to this charming end of terrace house, listed for sale and perfectly suited to first-time buyers. Nestled in a cul-de-sac location within Bridgegate offering excellent access for cycling & walking routes via the Bristol & Bath cycle track, this property promises a lifestyle that blends comfort, convenience, and a touch of nature.

This modern home boasts an open-plan living room / diner that is bathed in natural light, thanks to the large rear windows. The view of the garden from here is truly delightful, making this room the heart of the home. Step outside and you'll find access to a cosy private garden where you can enjoy your morning coffee or an evening read.

The property also encompasses a well-lit kitchen, ideal for those who love cooking. The space is well-designed, ensuring you can prepare your meals with ease.

The living space extends to two lovely bedrooms. The master bedroom is a real treat, featuring a mezzanine balcony that adds a unique touch to the room. The second bedroom is a comfortable double room, perfect for rest and relaxation.

Rounding off the property, there's a beautiful bathroom with a skylight window. This unique feature ensures you can indulge in a peaceful bath under a blanket of stars or wake up with the morning sunlight.

This house, with its unique features and ideal location, offers an excellent opportunity for first-time buyers to own a property that they can turn into a home. Discover the joys of living here, with the vibrancy of nature on your doorstep and the comfort of a well-designed space.

Council Tax Band B

****Please note that there is an Estate Management charge of £20.00 pcm to Twelve Trees Property Management.****







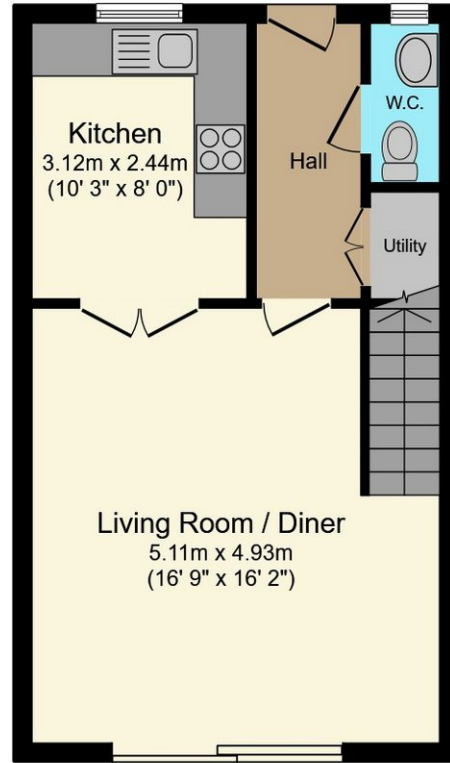

Ground Floor

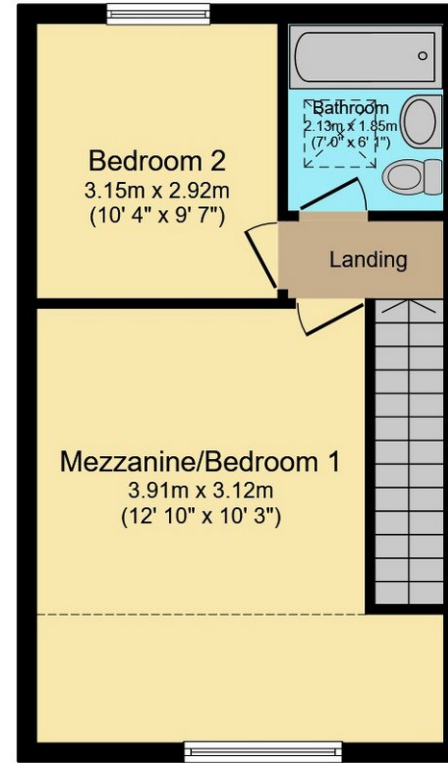

First Floor

This floor plan is for illustrative purposes only. It is not drawn to scale. Any measurements, floor areas (including any total floor area), openings and orientations are approximate. No details are guaranteed, they cannot be relied upon for any purpose and do not form any part of any agreement. No liability is taken for any error, omission or misstatement. A party must rely upon its own inspection(s). Powered by www.Propertybox.io



Guy Rolfe Moving You

03334041188 option 3

guy.rolfe@moving-you.co.uk

PROPERTY MISDESCRIPTIONS ACT 1991: The Agents has not tested any apparatus, equipment, fixtures and fittings, or services, so cannot verify that they are in working order or fit for the purpose. The buyer is advised to obtain verification from his or her Professional Buyer, References to the Tenure of the property are based on information supplied by the Vendor. The agents have not had sight of the title documents. The buyer is advised to obtain verification from their Solicitor. You are advised to check the availability of any property before travelling any distance to view.

www.moving-you.co.uk