

Moving You



Trinity Court, Kingswood, BS15 4FG

03334041188 option 3

Asking Price £390,000

[guy.rolfe@moving-you.co.uk](mailto:guy.rolfe@moving-you.co.uk)

Freehold

[www.moving-you.co.uk](http://www.moving-you.co.uk)









## Trinity Court, Kingswood, Bristol, BS15 4FG

This end of terrace town house, in immaculate condition and spread over three floors, features four spacious bedrooms, family bathroom, two en-suites and a cloakroom/W.C, two welcoming reception rooms, and a single integral garage, All located in a highly sought-after area with convenient access to public transport and local amenities.

Welcome to this delightful end of terrace town house that's up for sale and waiting to welcome you home. This is a rare gem with a pristine, immaculate condition that shows the love and care bestowed upon it.

The property boasts a well-laid out design spread over three floors, affording ample space for any family or buy to let investor. The heart of the home consists of two commodious reception rooms, ideal for entertaining guests or enjoying quiet evenings. These areas radiate warmth, making anyone feel right at home instantly.

The house presents four splendid bedrooms, each one a sanctuary of its own. The rooms are spacious, airy, and filled with natural light, providing the perfect environment for relaxation. The property also comprises a well-appointed bathroom, two en-suites and a cloakroom W.C, ensuring no morning rush clashes!

One of the unique features of this property is the integral garage, an excellent addition for safe vehicle storage but as it is accessible from the living space it would make an excellent home gym.

Located in a highly sought-after area close to amenities and bus routes at the High Street in Kingswood, this property benefits from having public transport links and local amenities within easy reach, adding to its overall appeal.

Whether you're an investor looking for a lucrative opportunity or a family seeking a new nest, this immaculate town house is sure to meet your expectations. It's more than just a house, it's a home with a heart.

Council Tax Band D









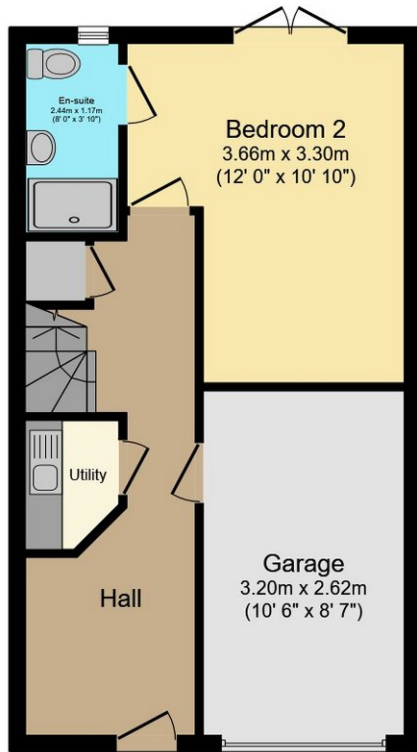

Ground Floor

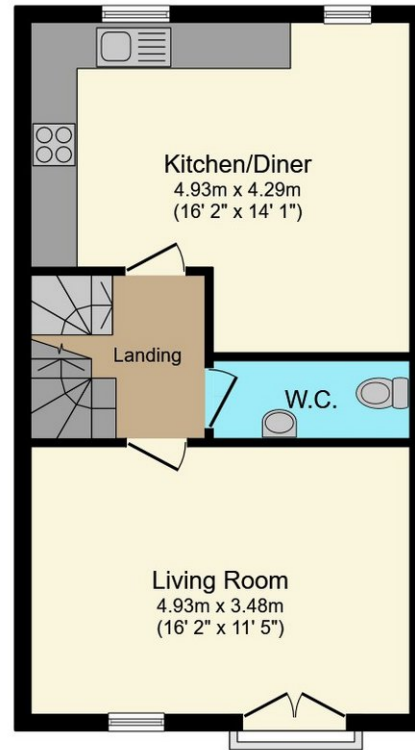

First Floor

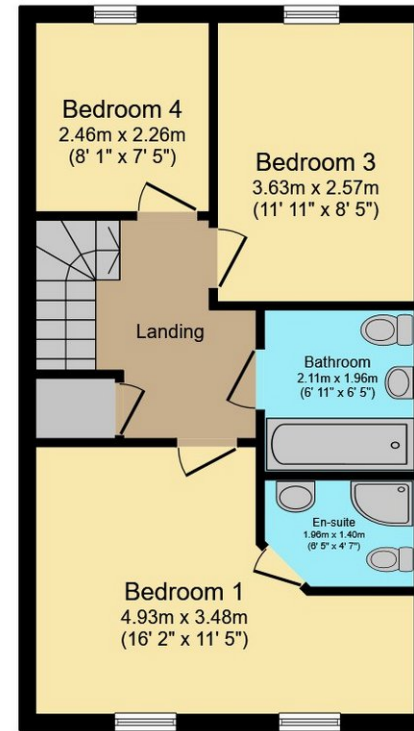

Second Floor

This floor plan is for illustrative purposes only. It is not drawn to scale. Any measurements, floor areas (including any total floor area), openings and orientations are approximate. No details are guaranteed, they cannot be relied upon for any purpose and do not form any part of any agreement. No liability is taken for any error, omission or misstatement. A party must rely upon its own inspection(s). Powered by [www.Propertybox.io](http://www.Propertybox.io)



Guy Rolfe Moving You

03334041188 option 3

[guy.rolfe@moving-you.co.uk](mailto:guy.rolfe@moving-you.co.uk)

PROPERTY MISDESCRIPTIONS ACT 1991: The Agents has not tested any apparatus, equipment, fixtures and fittings, or services, so cannot verify that they are in working order or fit for the purpose. The buyer is advised to obtain verification from his or her Professional Buyer, References to the Tenure of the property are based on information supplied by the Vendor. The agents have not had sight of the title documents. The buyer is advised to obtain verification from their Solicitor. You are advised to check the availability of any property before travelling any distance to view.

[www.moving-you.co.uk](http://www.moving-you.co.uk)