

Moving You



Cadbury Heath Road, Bristol

03334041188 option 3

Asking Price £270,000

guy.rolfe@moving-you.co.uk

Freehold

www.moving-you.co.uk









Cadbury Heath Road, Bristol, BS30 8BX

Good things come in small packages! This a charming character cottage is currently up for sale and might just be perfect for you. This lovely home is nestled in Warmley on the border with Cadbury Heath with a strong local community, making it a fantastic choice for first-time buyers looking to settle in a friendly and welcoming neighbourhood.

Upon entering the property, you'll find a cosy reception room that instantly catches your attention with a stunning wood burner. It's the perfect spot to curl up with a good book on those chilly evenings. Moving along, this home boasts a beautiful hand crafted kitchen where you can whip up your favourite meals. The kitchen is quite the heart of the home, where you can cook, eat, and create memories.

Upstairs, the property offers two well-sized bedrooms. The first is a generous double room, providing plenty of space for relaxation and storage. The second bedroom is a single room, but it's by no means small and comes with built-in wardrobes, making it a great space for a child's room or a home office.

To complete this charming home, there is a well-appointed bathroom, offering all the essentials you need for a comfortable living.

Externally this home benefits from a pretty courtyard garden offering enough space for family barbeques or a morning coffee and located to the front of the property are two off street parking spaces accessed via the shared driveway.

All in all, this endearing terraced property is a wonderful option for those looking to step on the property ladder. A house that feels like a home from the moment you step inside, why not come and take a look for yourself?

Council Tax B







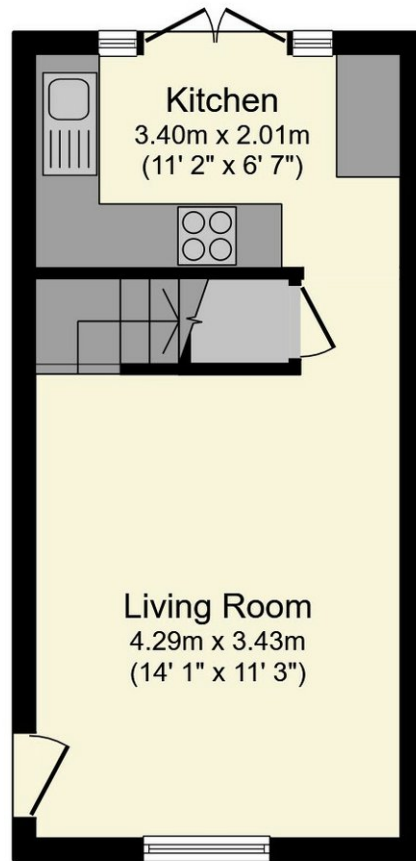

Ground Floor

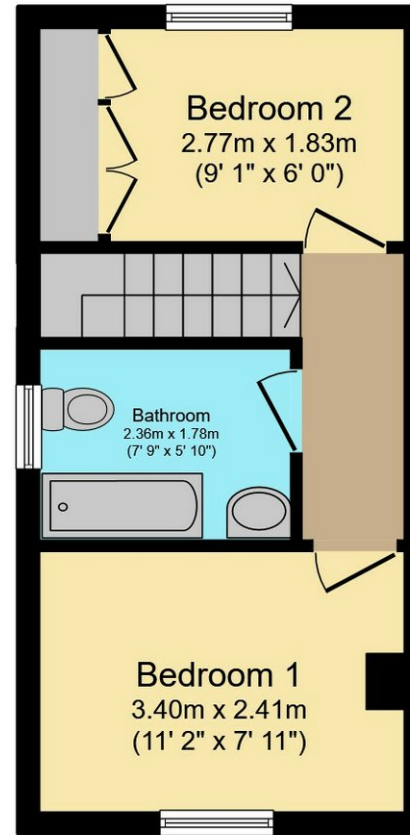

First Floor

This floor plan is for illustrative purposes only. It is not drawn to scale. Any measurements, floor areas (including any total floor area), openings and orientations are approximate. No details are guaranteed, they cannot be relied upon for any purpose and do not form any part of any agreement. No liability is taken for any error, omission or misstatement. A party must rely upon its own inspection(s). Powered by www.Propertybox.io



Guy Rolfe Moving You

03334041188 option 3

guy.rolfe@moving-you.co.uk

PROPERTY MISDESCRIPTIONS ACT 1991: The Agents has not tested any apparatus, equipment, fixtures and fittings, or services, so cannot verify that they are in working order or fit for the purpose. The buyer is advised to obtain verification from his or her Professional Buyer, References to the Tenure of the property are based on information supplied by the Vendor. The agents have not had sight of the title documents. The buyer is advised to obtain verification from their Solicitor. You are advised to check the availability of any property before travelling any distance to view.

www.moving-you.co.uk