

Bristol East

Parsons Walk
Bristol
Gloucestershire
BS30 5WA



426 Soundwell Road, Kingswood,
Bristol, BS15 1JS

**Offers in region
of £156,000**



This charming flat, located in an urban area with excellent public transport links and local amenities, features a welcoming reception room which is open-plan with the kitchen area, a good sized bedroom, a well-appointed bathroom, and its very own allocated parking space, making it an ideal opportunity for first-time buyers and investors alike. The property is also offered with no chain.

Allocated Parking Bay - Number 2

Council Tax A

Leasehold with 999 years from 01/01/2001.
Annual Management Charge £1020.00



03334041188 option 3
guy.rolfe@moving-you.co.uk
<https://www.moving-you.co.uk>

Features

EPC

- Urban location
- Excellent public transport links
- Nearby local amenities
- Bright reception room
- Open-plan living / kitchen area
- Good sized bedroom
- No chain
- Allocated parking space
- Perfect for first-time buyers

Energy Efficiency Rating		Current	Potential
Very energy efficient - lower running costs			
(92 plus)	A		
(81-91)	B		
(69-80)	C		
(55-68)	D	67	74
(39-54)	E		
(21-38)	F		
(1-20)	G		
Not energy efficient - higher running costs			

Floorplan

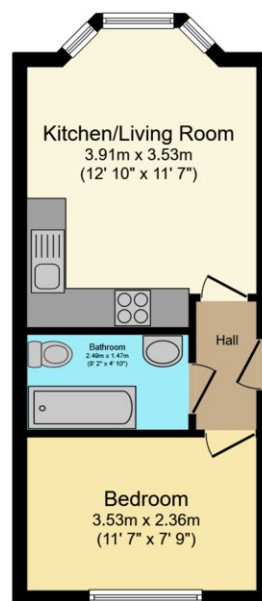

Floor Plan

This floor plan is for illustrative purposes only. It is not drawn to scale. Any measurements, floor areas (including any total floor area), openings and orientations are approximate. No details are guaranteed, they cannot be relied upon for any purpose and do not form any part of any agreement. No liability is taken for any error, omission or misstatement. A party must rely upon its own inspection(s). Powered by www.Propertybox.io



03334041188 option 3
 guy.rolfe@moving-you.co.uk
<https://www.moving-you.co.uk>