



Moving You



Westons Brake, Emersons Green
03334041188 option 3

Asking Price £280,000
guy.rolfe@moving-you.co.uk

Freehold
www.moving-you.co.uk









Westons Brake, Bristol, BS16 7EQ

This charming modern semi-detached home, ideal for first-time buyers, features a cosy living room, a practical open plan kitchen/diner, two double bedrooms, a stylish bathroom, and is conveniently located near public transport and local amenities.

Welcome to this charming Taywood built semi-detached house, a perfect little gem that's just waiting for you to make it your own. Perfectly suited for first-time buyers, this home is the ideal place to start your journey of property ownership.

The heart of this lovely home is its warm open-plan reception room, a beautiful space that invites you in and makes you feel instantly at home. The room is perfect for cosy evenings in or for hosting guests in a warm and welcoming environment.

Speaking of hosting, the house is equipped with an open plan kitchen/diner that's just waiting for you to cook up a storm. It's a space that's as practical as it is beautiful overlooking the rear garden, and it's perfect for everything from quiet breakfasts to dinner parties.

The house also boasts two double bedrooms that are just waiting for you to add your personal touch. Whether you want to create a peaceful retreat or a vibrant, energising space, these rooms offer a blank canvas for you to work with.

Completing the home is the family bathroom that's as practical as it is stylish, offering the perfect space for you to unwind after a long day.

The property is conveniently located with excellent public transport links via the A4174 Ring Road offering access to the M32/M4/M5 corridors and local amenities nearby, making your day-to-day life a breeze. This home isn't just a property; it's a lifestyle, and it's one that's waiting for you to embrace it. Don't wait around; this house won't be on the market for long. Your dream home is just a call away!

Council Tax Band C







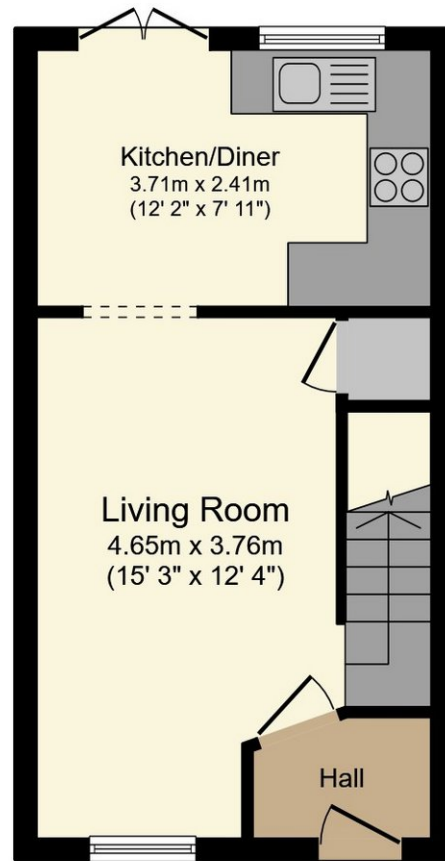

Ground Floor

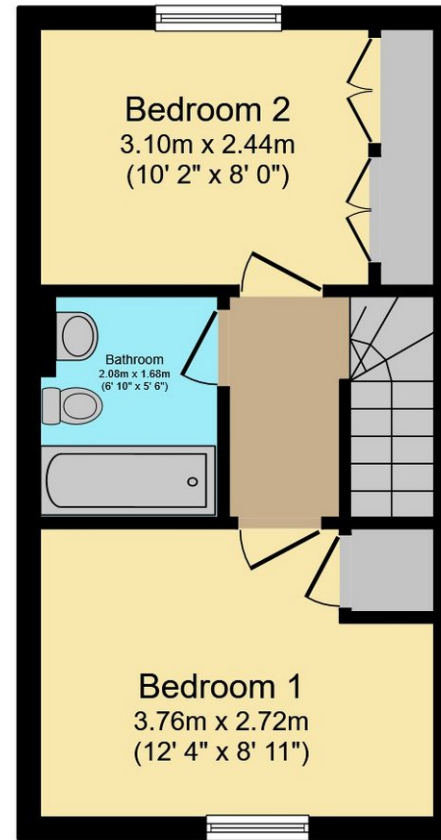

First Floor

This floor plan is for illustrative purposes only. It is not drawn to scale. Any measurements, floor areas (including any total floor area), openings and orientations are approximate. No details are guaranteed, they cannot be relied upon for any purpose and do not form any part of any agreement. No liability is taken for any error, omission or misstatement. A party must rely upon its own inspection(s). Powered by www.Propertybox.io



Guy Rolfe Moving You 03334041188 option 3 guy.rolfe@moving-you.co.uk

PROPERTY MISDESCRIPTIONS ACT 1991: The Agents has not tested any apparatus, equipment, fixtures and fittings, or services, so cannot verify that they are in working order or fit for the purpose. The buyer is advised to obtain verification from his or her Professional Buyer, References to the Tenure of the property are based on information supplied by the Vendor. The agents have not had sight of the title documents. The buyer is advised to obtain verification from their Solicitor. You are advised to check the availability of any property before travelling any distance to view.

www.moving-you.co.uk