

The logo for 'Moving You' is located in the top right corner. It consists of the words 'Moving You' in a black, cursive-style font on a bright yellow rectangular background. A small house icon is visible in the bottom right corner of the yellow box.

London Road, Warmley, Bristol
03334041188 option 3

Offers Over £450,000
guy.rolfe@moving-you.co.uk

Freehold
www.moving-you.co.uk









London Road, Bristol, BS30 5JL

Welcome to this unique immaculate modern detached home, now available for sale on the edge of Bristol. Nestled in an area blessed with green spaces on the borders of Warmley and Bridgeyate, frequented walking and cycling routes via the Bristol/Bath cycle track and an engaging local community, this home is a haven for couples seeking a tranquil life.

This fabulous home features two double bedrooms, the master bedroom is a sanctuary of natural light and comfort. It boasts an en-suite for your convenience, offering an intimate, private space with the benefit of underfloor heating. The second bedroom is a welcoming double, providing ample space for relaxation and offers access via a drop down ladder to a sizeable loft room suitable for storage or conversion.

The bathroom is generously sized with underfloor heating, perfect for unwinding after a long day. The heart of the home however, is the ground floor open-plan space, incorporating a modern fully equipped kitchen with integrated appliances and quartz countertops, an ideal dining space, making the perfect spot for entertaining or enjoying quiet meals and finally the room is completed by the living area enjoying a garden view with bi fold doors and inset wood burning stove, exuding warmth and homeliness. It's the perfect space to curl up with a good book or enjoy a cosy night in.

Additionally, this superb property offers ground floor underfloor heating, a handy utility room, W.C, an attractive southerly facing rear garden alongside a wildlife corridor and the convenience of twin parking, ensuring your vehicle is safely accommodated accessed via the shared driveway.

This home is the embodiment of comfort and modern living. Its lovely features and handy location make it a great choice for couples seeking a sanctuary.

Council Tax Band C







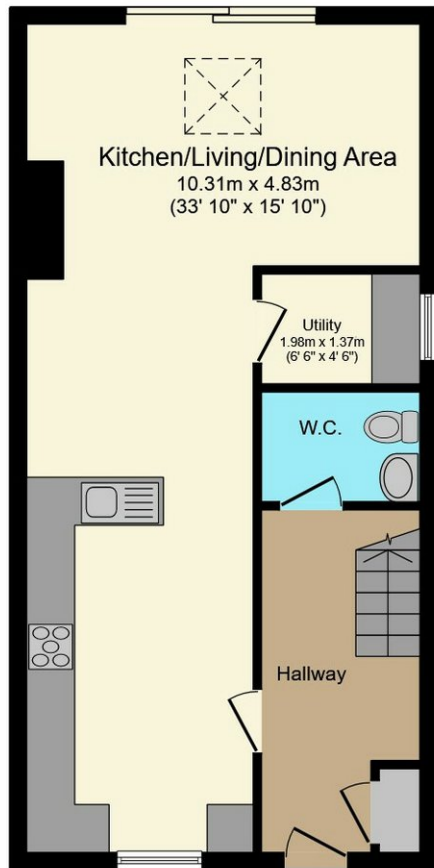

Ground Floor

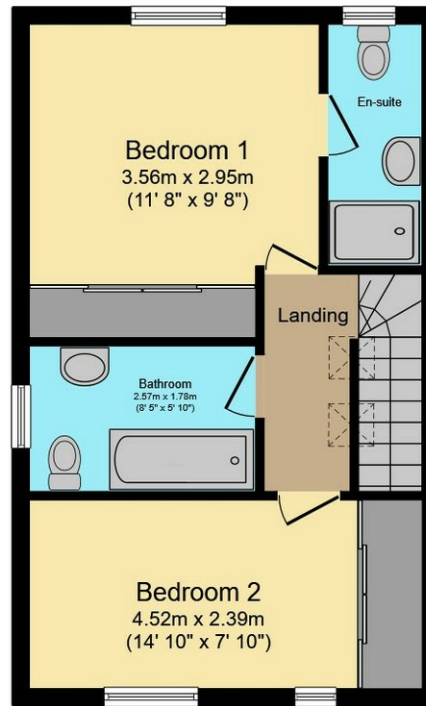

First Floor

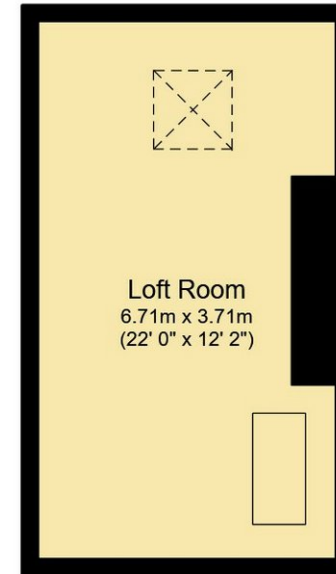

Second Floor

This floor plan is for illustrative purposes only. It is not drawn to scale. Any measurements, floor areas (including any total floor area), openings and orientations are approximate. No details are guaranteed, they cannot be relied upon for any purpose and do not form any part of any agreement. No liability is taken for any error, omission or misstatement. A party must rely upon its own inspection(s). Powered by www.Propertybox.io



Guy Rolfe Moving You

03334041188 option 3

guy.rolfe@moving-you.co.uk

PROPERTY MISDESCRIPTIONS ACT 1991: The Agents has not tested any apparatus, equipment, fixtures and fittings, or services, so cannot verify that they are in working order or fit for the purpose. The buyer is advised to obtain verification from his or her Professional Buyer, References to the Tenure of the property are based on information supplied by the Vendor. The agents have not had sight of the title documents. The buyer is advised to obtain verification from their Solicitor. You are advised to check the availability of any property before travelling any distance to view.

www.moving-you.co.uk